

**Head Office:**  
Dixon Kelley Estate Agents  
1 Penn Court  
Station Road, West Moors  
Dorset. BH22 0JJ

# DORSET PARK HOMES

**DRAFT**

[www.dorsetparkhomes.com](http://www.dorsetparkhomes.com)

**Telephone: 01202 877511**

**29b Doveshill Park, Barnes Road, Ensbury Park, Bournemouth. BH10 5AJ**



**Spacious Home with Delightful Patio Garden**

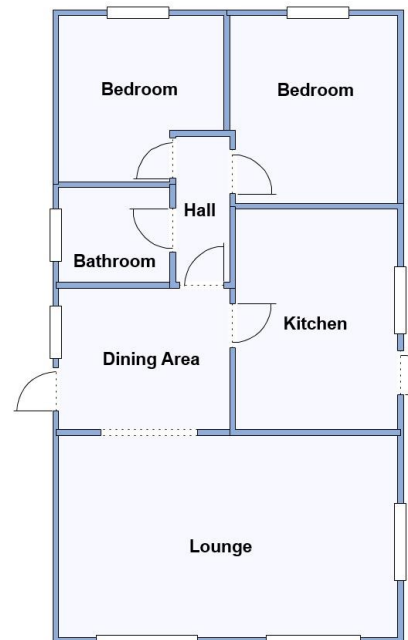

This drawing has been prepared for diagrammatic purpose only. Not to scale.

## 2-Bedroom Park Home - approx 36' x 20'

**Accommodation & approximate room dimensions:**

- Omar 'Oulton' 1993
- Kitchen: approx 12'7" x 9'2". Range of floor and wall cupboards. Space for cooker, tall fridge/freezer & washing machine. Airing Cupboard.
- Lounge: approx 19'4" x 11'8". Feature fireplace with gas fire & back boiler (untested).
- Dining Area: approx 9'9" x 8'1". Door to garden.
- Inner Hall
- Bedroom 1: approx 10'8" x 9'5". Fitted wardrobes and dressing table.
- Bedroom 2: approx 9'8" x 9'5". Built in wardrobe.
- Bathroom: Panelled bath. Wash Basin and WC.
- Gas Central Heating (system untested)
- PVCu Double-Glazing
- Delightful Patio Garden with Metal Shed
- Parking on rental basis subject to availability (approx £14.59 per month)
- Age Restriction 55+
- No Pets
- Well maintained Residential Park close to local amenities & Bournemouth Town Centre.

## Close to Amenities



**Price: £125,000**

**Pitch Fee: approx £224.84 per month. Water & Sewerage £12.77  
Subject to Annual Review  
Council Tax Band: 'A' Tenure: 1983 Mobile Homes Act Agreement**

**VIEWING STRICTLY BY APPOINTMENT WITH THE VENDOR'S AGENT Dorset Park Homes 01202 877511**

**IMPORTANT NOTE:** These particulars are believed to be correct but their accuracy is not guaranteed. They do not form part of any contract. Nothing in these particulars shall be deemed to be a statement that the property is in good structural condition or otherwise, nor that any of the services, appliances, equipment or facilities are in good working order or have been tested. Purchasers should satisfy themselves on such matters prior to purchase Ref.W04575

*The recommended specialist in Park Home sales*  
Partner: Simon Dixon

